



TRANSPORTATION CABINET

Frankfort, Kentucky 40622
www.transportation.ky.gov/

Steven L. Beshear
Governor

Michael W. Hancock, P.E.
Secretary

December 2, 2011

CALL NO. 101
CONTRACT ID NO. 111353
ADDENDUM # 1

Subject: Graves County, HSIP 9010 (041)
Letting December 9, 2011

- (1) Revised - Plan Sheets - R2, R2a, & R9
- (2) Revised - Bid Items - Pages 102-103 of 103

Proposal revisions are available at <http://transportation.ky.gov/contract/>.
Plan revisions are available at <http://www.lynnimaging.com/kytransportation/>.

If you have any questions, please contact us at 502-564-3500.

Sincerely,

A handwritten signature in blue ink that reads "Ryan Griffith".

Ryan Griffith
Director
Division of Construction Procurement

RG:ks
Enclosures



An Equal Opportunity Employer M/F/D

TYPICAL SECTION

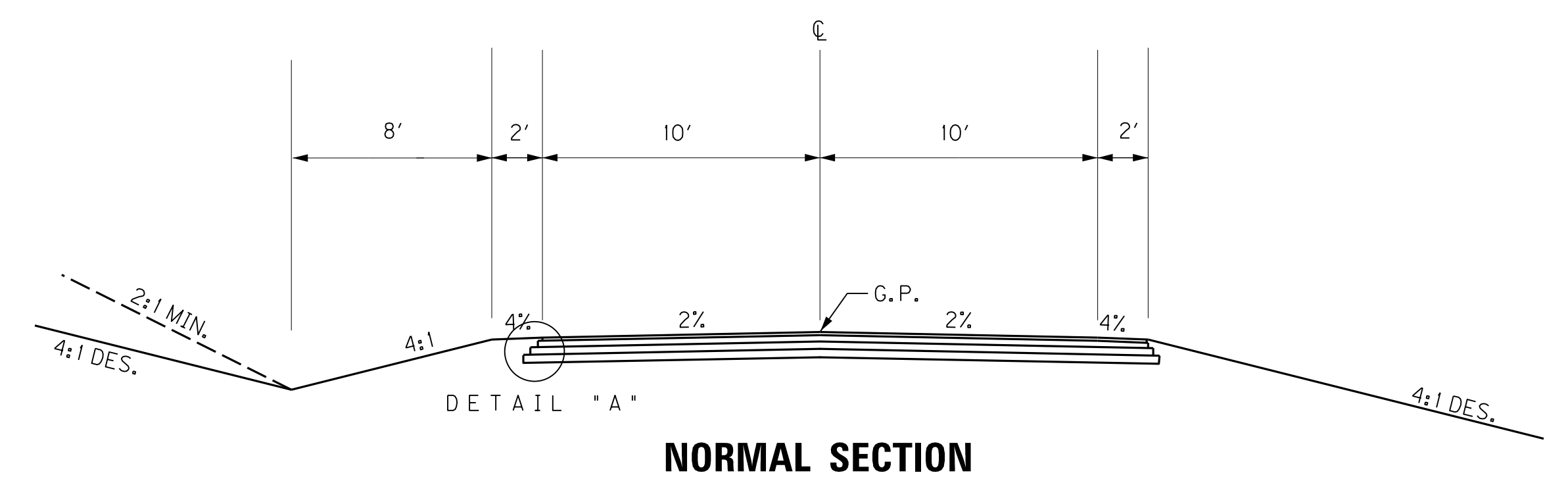

SEE CROSS SECTIONS FOR SLOPES
OUTSIDE THE LIMITS OF THE TYPICAL
SECTION

PAVEMENT SCHEDULE

MAINLINE AND APPROACH ROAD
 1 1/2" Asphalt Surface
 6 1/2" Asphalt Base (3" + 3 1/2")
 4" DGA Base
SHOULDER
 EARTH

ENTRANCES
 1 1/2" Asphalt Surface
 2 1/4" Asphalt Base
 4" DGA Base

SHOULDER
 EARTH

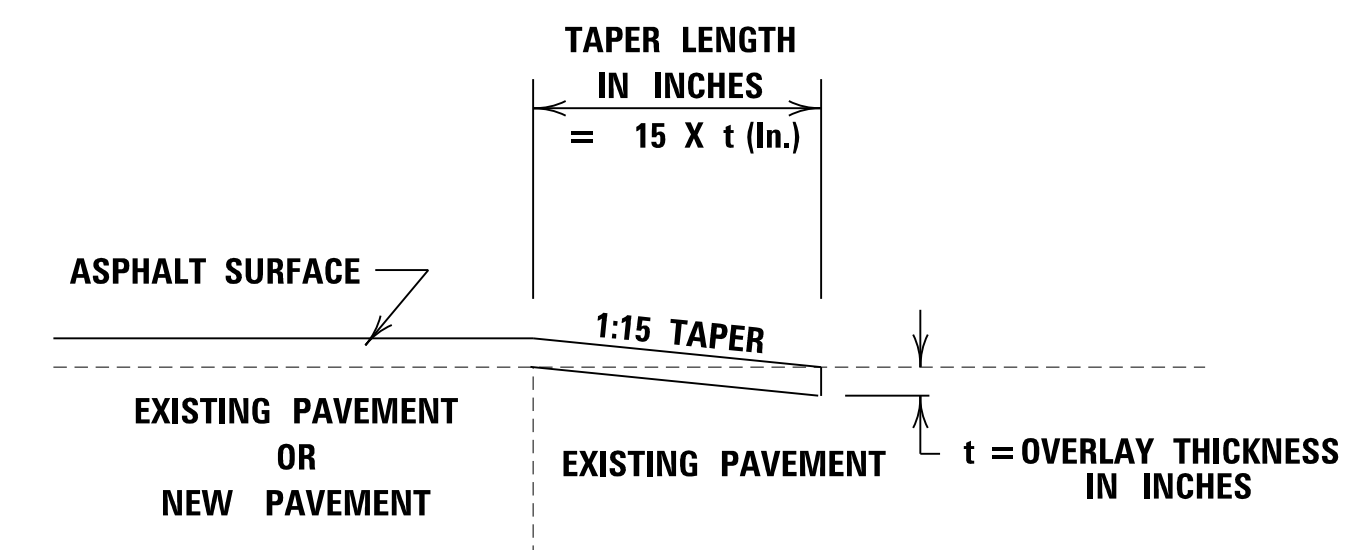

EDGE KEY DETAIL

Work under this item shall include cutting out the existing asphalt surface to a minimum depth and width as shown, so the new surface may heel into the existing surface. The contract unit price bid per linear foot for "EDGE KEY" shall include all necessary materials, labor, equipment, etc. to perform the work and dispose of the asphalt material removed.

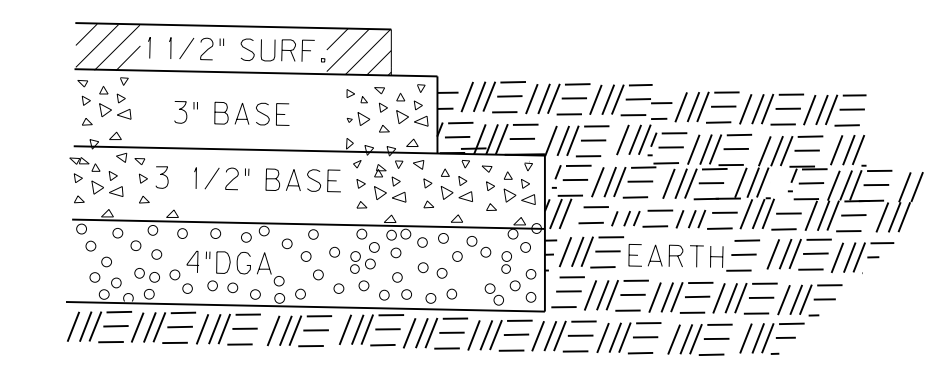
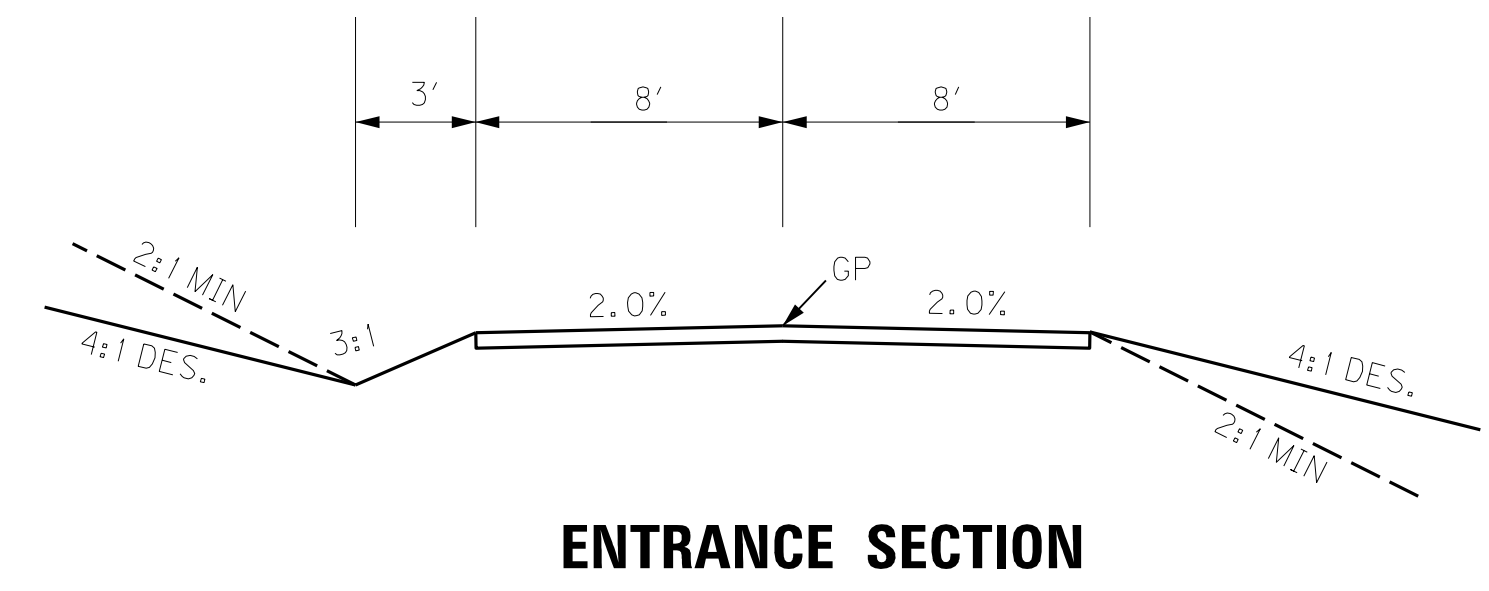

SCALE: 1"=

TYPICAL SECTION

FILE NAME: C:\PWORK\JEFFERY.SUTTON\00466475\00200TS.DGN
 USER: jeffery.sutton
 DATE PLOTTED: December 1, 2011
 E-SHEET NAME: 00200TS
 MicroStation v8.11.7.180

December 1, 2011

TYPICAL SECTION

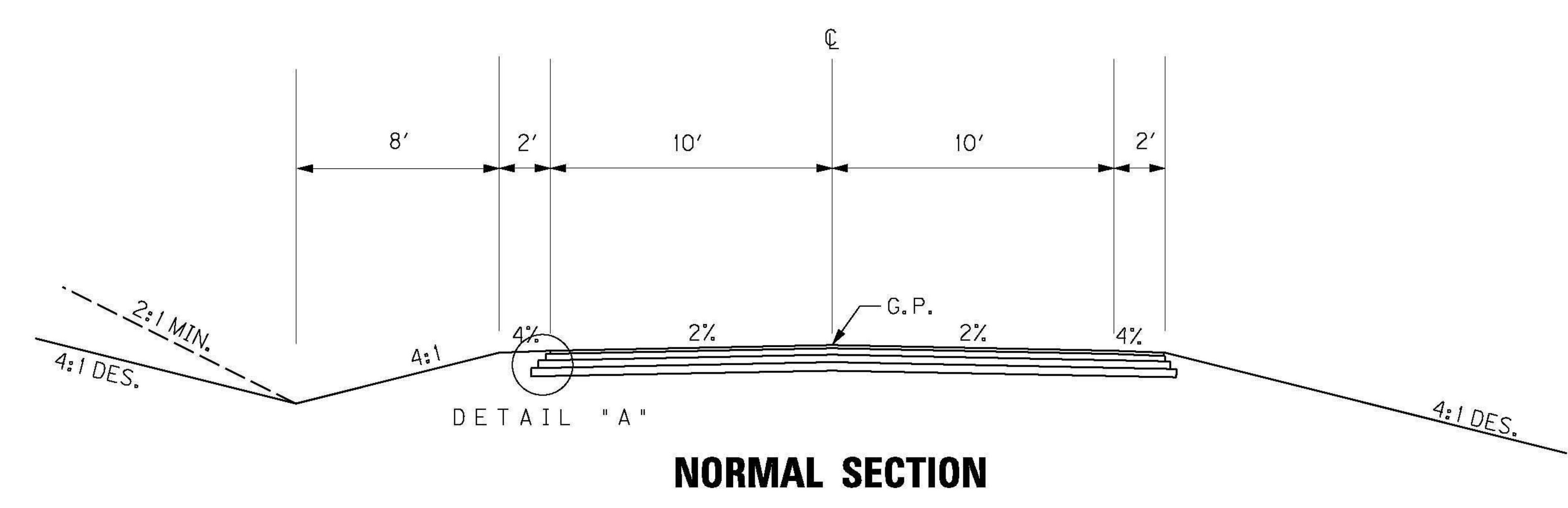

SEE CROSS SECTIONS FOR SLOPES OUTSIDE THE LIMITS OF THE TYPICAL SECTION

PAVEMENT SCHEDULE

MAINLINE AND APPROACH ROAD
 1 1/2" Asphalt Surface
 6 1/2" Asphalt Base (3" + 3 1/2")
 4" DGA Base
 SHOULDER
 EARTH

ENTRANCES

1 1/2" Asphalt Surface
 2 1/4" Asphalt Base
 4" DGA Base
 SHOULDER
 EARTH

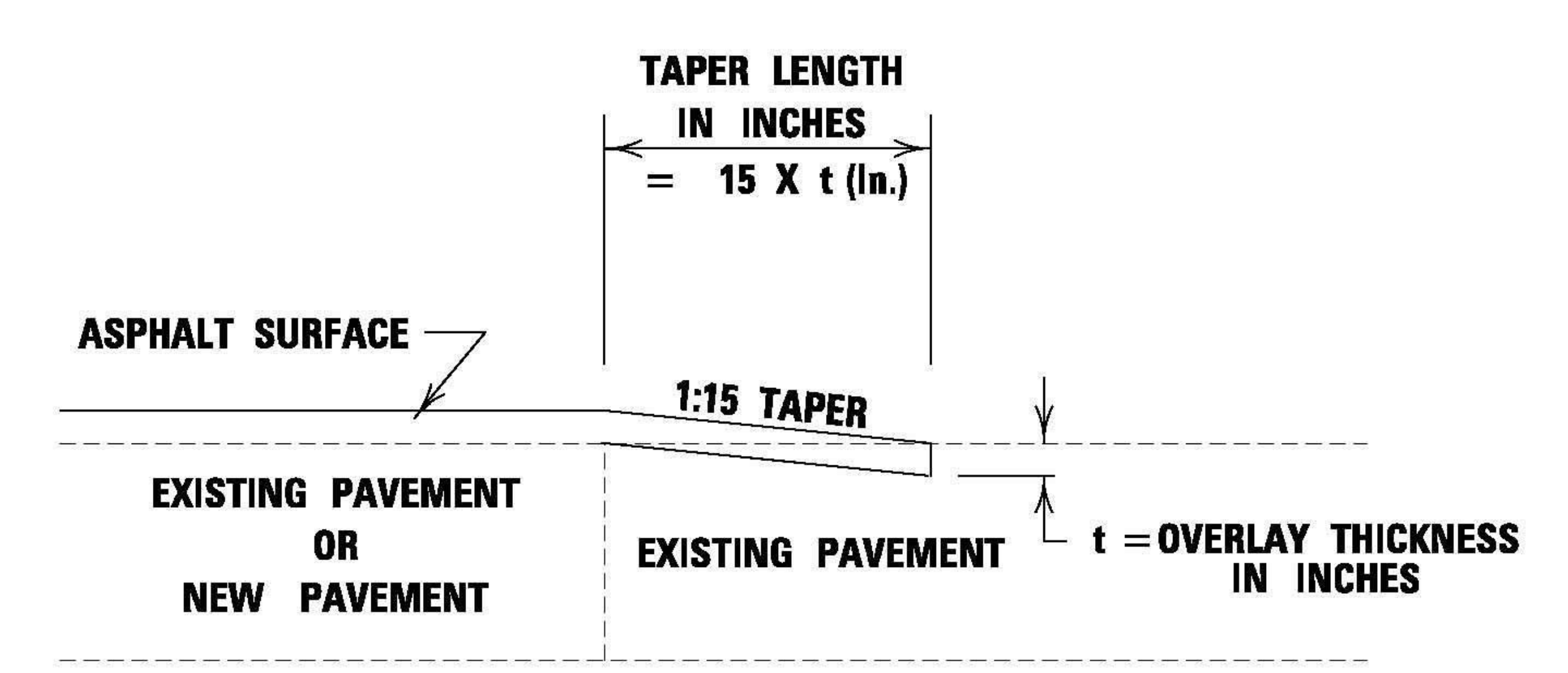
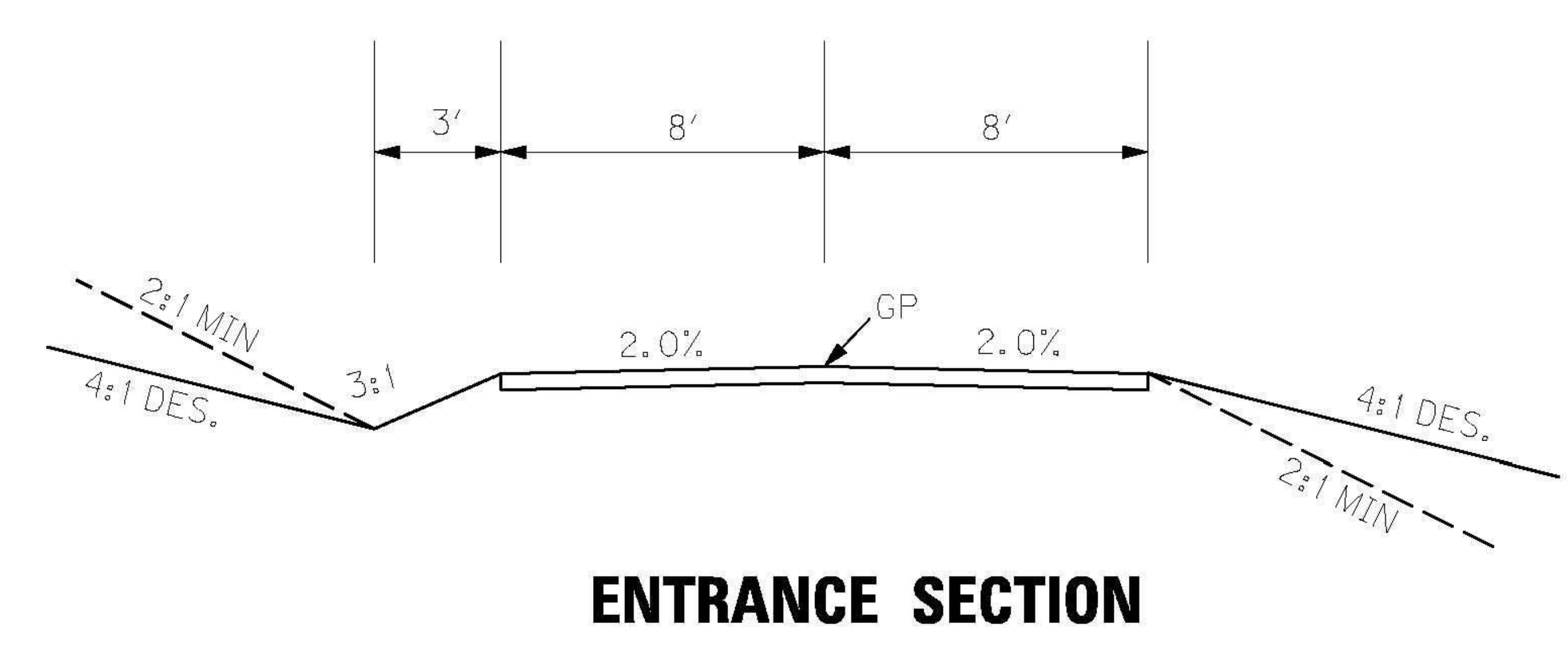
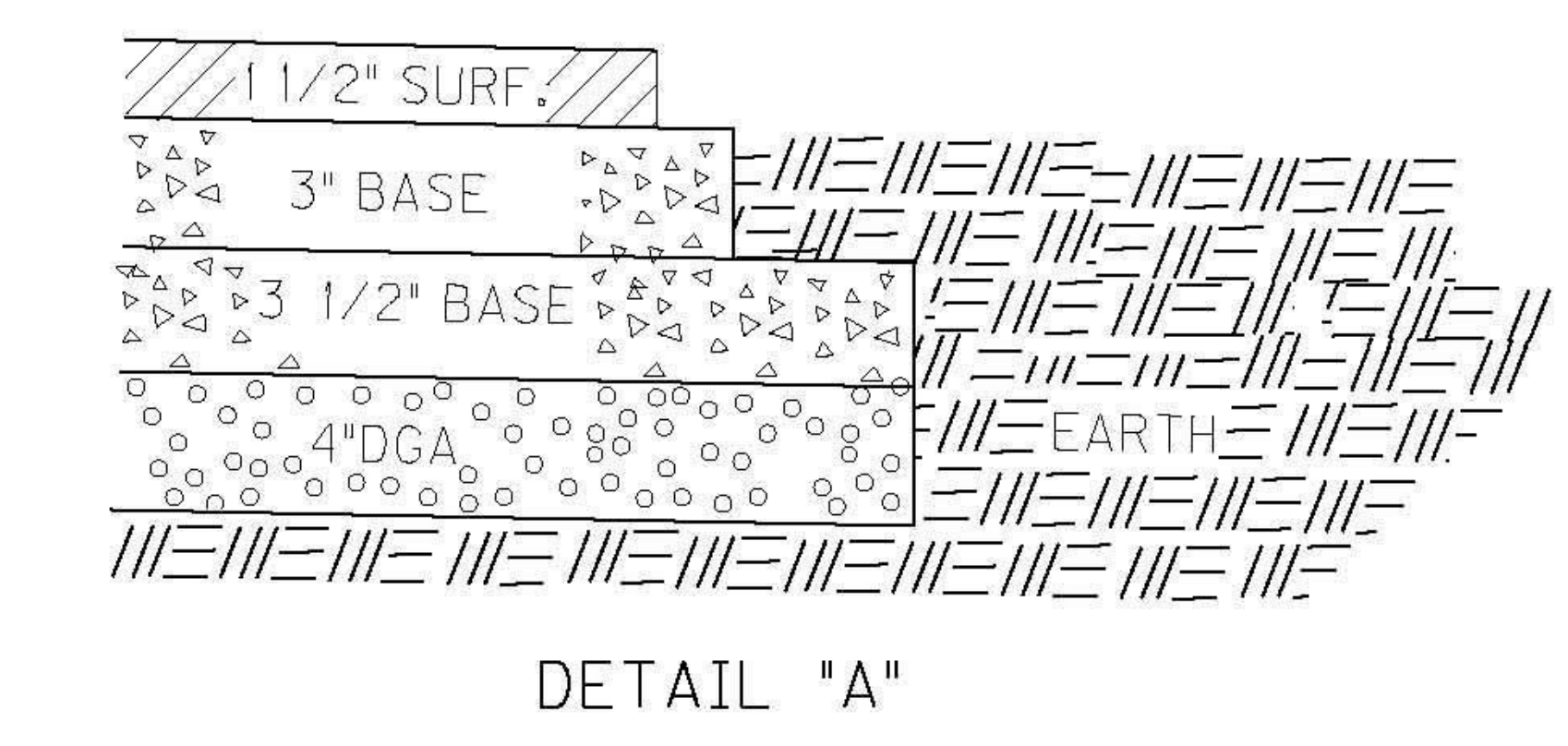

EDGE KEY DETAIL

Work under this item shall include cutting out the existing asphalt surface to a minimum depth and width as shown, so the new surface may heel into the existing surface. The contract unit price bid per linear foot for "EDGE KEY" shall include all necessary materials, labor, equipment, etc. to perform the work and dispose of the asphalt material removed.

SCALE: 1"=

TYPICAL SECTION

FILE NAME: C:\PWORK\JEFFERY.SUTTON\00466475\00200TS.DGN
 USER: jeffery.sutton
 DATE PLOTTED: December 1, 2011
 E-SHEET NAME: 00200TS
 MicroStation v8.11.7.180

PIPE DRAINAGE SHEET 1 of 1

COUNTY OF	ITEM NO.	SHEET NO.
GRAVES	1-901.00	R9

CULVERT PIPE										DESIGN PH LEVEL	MAX. COVER HEIGHT	FABRIC GEOTEXTILE TYPE IV	METAL END SECT. TY. 3 -36"	EROSION CONTROL BLANKET						
36"										L-M-H	FEET	S.Y.	EACH	S.Y.						
										M	2.2	15	1	668						

L I N E A R F E E T

MicroStation v8.1i.7.180 E-SHEET NAME: R00900PS USER: jeffery.sutton DATE PLOTTED: January 1, 2001 FILE NAME: C:\PWORK\JEFFERY.SUTTON\00466475\R00900PS.DGN

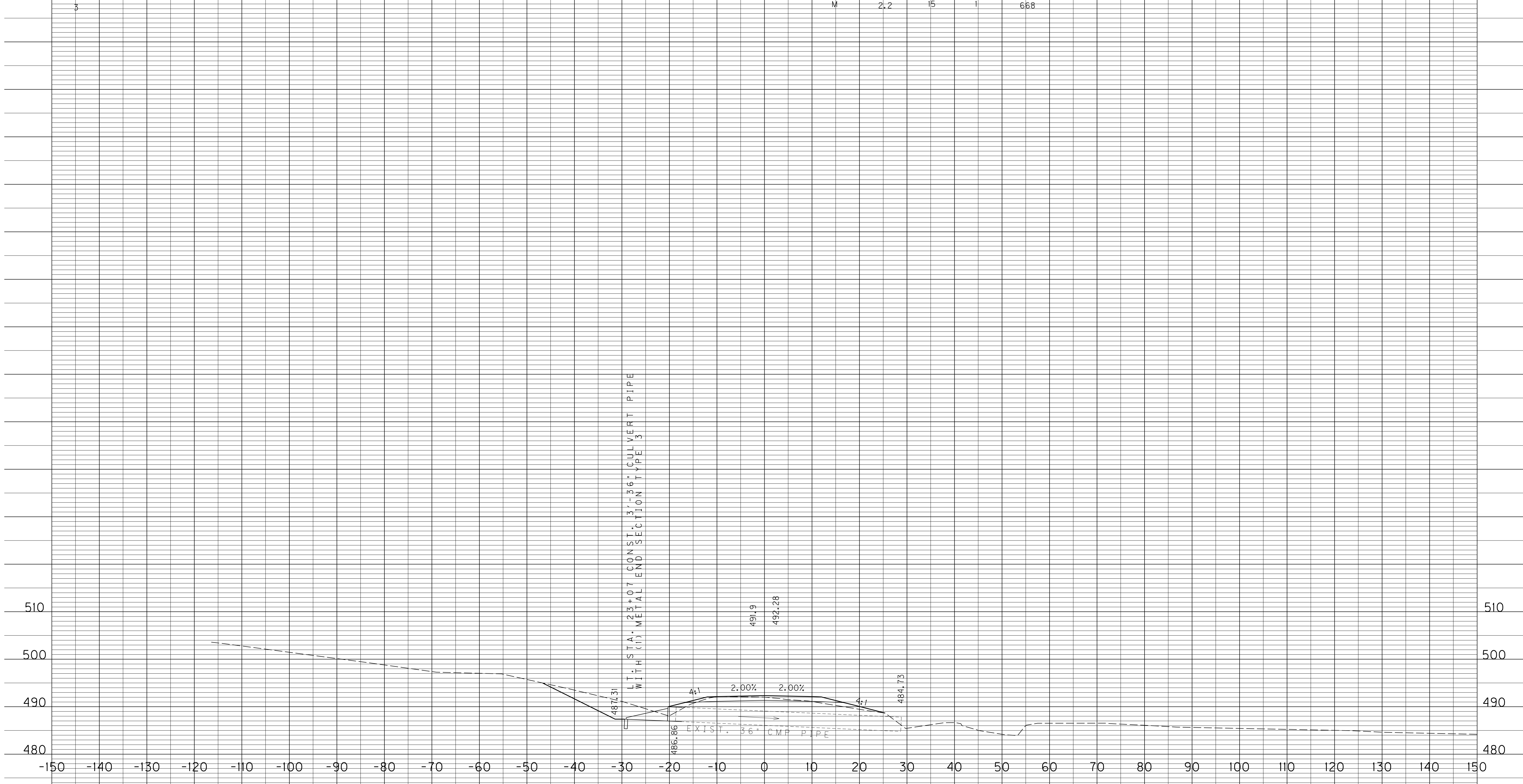

SCALE: 1"=10'

PIPE SECTION

CONTRACT ID: 111353
COUNTY: GRAVES
PROPOSAL: HSIP 9010 (041)

PAGE: 1
LETTING: 12/09/11
CALL NO: 101

LINE NO	ITEM	DESCRIPTION	APPROXIMATE QUANTITY	UNIT	UNIT PRICE	AMOUNT
SECTION 0001 ROADWAY						
0010	00001	DGA BASE	519.000	TON		
0020	00212	CL2 ASPH BASE 1.00D PG64-22 (REVISED: 12-2-11)	636.000	TON		
0021	00221	CL2 ASPH BASE 0.75D PG64-22 (ADDED: 12-2-11)	15.000	TON		
0030	00301	CL2 ASPH SURF 0.38D PG64-22	155.000	TON		
0040	00468	CULVERT PIPE-36 IN	3.000	LF		
0050	01395	METAL END SECTION TY 3-36 IN	1.000	EACH		
0060	02014	BARRICADE-TYPE III	3.000	EACH		
0070	02159	TEMP DITCH	1,500.000	LF		
0080	02200	ROADWAY EXCAVATION	4,219.000	CUYD		
0090	02242	WATER	130.000	MGAL		
0100	02267	REMOVE & RESET FENCE	182.000	LF		
0110	02545	CLEARING AND GRUBBING (0.57 ACRES)	(1.00)	LS		
0120	02562	SIGNS	174.000	SQFT		
0130	02585	EDGE KEY	36.000	LF		
0140	02600	FABRIC GEOTEXTILE TY IV FOR PIPE	15.000	SQYD	2.00	30.03
0150	02650	MAINTAIN & CONTROL TRAFFIC	(1.00)	LS		
0160	02701	TEMP SILT FENCE	750.000	LF		
0170	02704	SILT TRAP TYPE B	2.000	EACH		
0180	02707	CLEAN SILT TRAP TYPE B	6.000	EACH		
0190	02709	CLEAN TEMP SILT FENCE	750.000	LF		

CONTRACT ID: 111353
COUNTY: GRAVES
PROPOSAL: HSIP 9010 (041)

PAGE: 2
LETTING: 12/09/11
CALL NO: 101

LINE NO	ITEM	DESCRIPTION	APPROXIMATE QUANTITY	UNIT	UNIT PRICE	AMOUNT
0200	02726	STAKING	(1.00)	LS		
0210	05950	EROSION CONTROL BLANKET	668.000	SQYD		
0220	05966	TOPDRESSING FERTILIZER	0.400	TON		
0230	05985	SEEDING AND PROTECTION	2,867.000	SQYD		
0240	06514	PAVE STRIPING-PERM PAINT-4 IN	1,500.000	LF		
0250	23131ER701	PIPELINE VIDEO INSPECTION	48.000	LF		
SECTION 0002 DEMOBILIZATION						
0260	02569	DEMOBILIZATION (AT LEAST 1.5%)		LUMP		
		TOTAL BID				